

TROPIC

MODEL: **FAC16663A** | **16X66** | **1,034 SQ. FT.** | **3 BED 2 BATH**

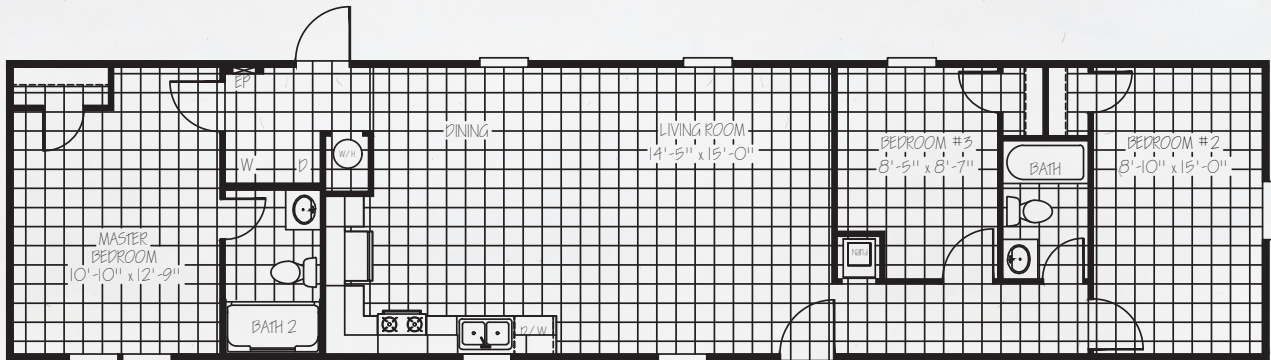

STANDARD FEATURES

- HARDWOOD CABINET DOORS
- LINO THROUGH OUT
- DISHWASHER
- 54" FIBERGLASS TUB GUEST BATH
- CHINA SINKS IN BOTH BATHS
- DOUBLE SINKS MASTER BATH

- ELONGATED TOILETS
- 2" MINI BLINDS THROUGHOUT
- MASTER WATER SHUT OFF
- CEILING FAN LIVING ROOM
- R21-11-11 FIBERGLASS INSULATION
- LOW E THERMAL PANE WINDOWS

- SUNBURST STEEL FRONT DOOR
- SHUTTERS FRONT DOOR SIDE
- 16" ON CENTER FLOOR JOIST
- OSB W/HOUSE WRAP ON VINYL SIDED HOMES

OPTIONS AVAILABLE

- WIND ZONE II
- ENERGY STAR (33/12/22)
- SMART PANEL SIDING

- GAS FURNACE / GAS RANGE
- 60" FIBERGLASS SHOWER MASTER BATH
- 50 GALLON WATER HEATER

- ADDITIONAL CEILING FAN (MBR)
- FORNO STAINLESS STEEL APPLIANCES